

rev date by revisions

A	08.01.21	VPP	application boundary updated; existing car park shown in more detail
B	15.01.21	VPP	application boundary updated; existing car park spaces shown
C	28.01.21	VPP	application boundary updated
D	08.03.21	VPP	land ownership boundary added

key plan

- application boundary
- land ownership boundary

notes



architect

**Lifschutz Davidson Sandilands**  
 Island Studios, 22 St. Peter's Square, London W6 9NW T +44 (0)20 8600 4800 mail@lds-uk.com

project	drawing title		
Tesco store site Highbridge Road, Barking	Site Location Plan		
client	scale at A1	scale at A3	drawn date
EcoWorld International	1:1250	1:2500	RF 01.21
	job no.	drawing	rev.
	1133	X1000	D

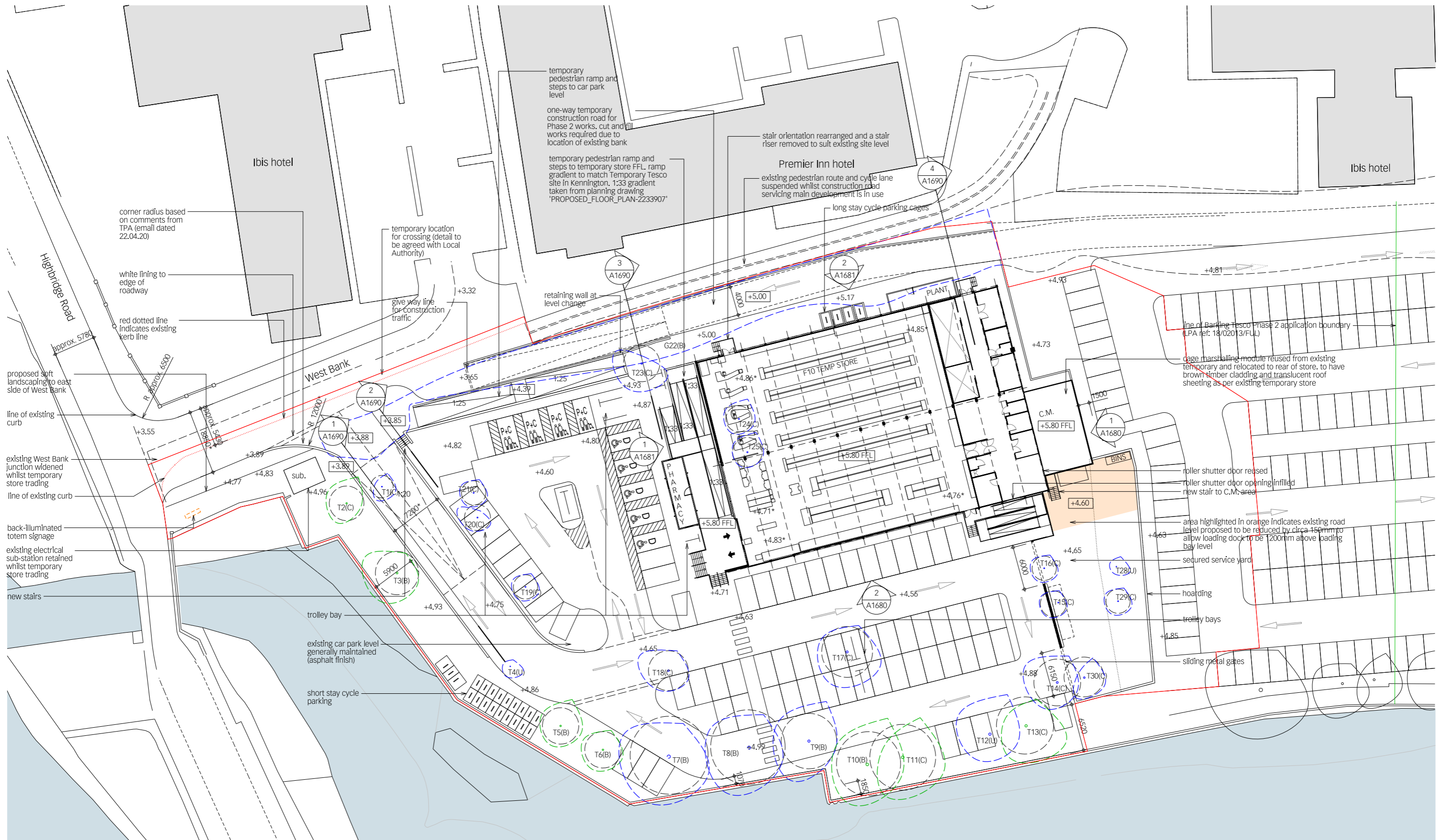

rev date by revisions

- A 08.01.21 RF application boundary updated, totem sign added.
- B 14.01.21 VPP plan updated as agreed with Tesco 11.01.21; bin storage in loading bay relocated; pedestrian crossing through east car park shifted north; car park schedule updated; trees along West Bank north of application boundary to be retained; ramp added to north-east means of escape; West Bank construction route levels amended
- C 20.01.21 VPP stair added to C.M. area
- D 21.01.21 VPP application boundary amended to include car park rearrangement north of store; note added to describe cladding of C.M. area
- E 25.01.21 VPP cycle route to the rear of the existing hotels to the west of the site to be suspended whilst temporary store in use; Trees T10, T11, T13 to be retained, car park and service yard modified to Tesco's comments and application boundary modified to suit.
- F 27.01.21 VPP service yard reverted to size in revision D and subsequently standard car parking spaces reduced by 3
- G 28.01.21 VPP application boundary at West Bank updated

key plan

- application boundary
- Tesco Barking Phase 2 boundary (previous application) (LPA ref: 18/02013/FUL)
- +X.XX existing retained level
- [+X.XX] proposed new level
- +X.XX\* existing retained ground level beneath store
- tree to be retained
- tree to be removed

notes

Vehicular access and working access zone around temporary store car park for Environment Agency inspection / repairs to the riverwall are subject to EA approval.  
 delivery lorry swept paths are based on detailed tracking by Cole Easdon tracking dated 06.07.20 on SK1096.

Parking schedule:  
 66 standard spaces  
 5 disabled spaces  
 4 P+C spaces

total: 75 spaces

42 short stay cycle spaces  
 8 long stay cycle spaces

architect

**Lifschutz Davidson Sandilands**

Island Studios, 22 St. Peter's Square, London W6 9NW T +44 (0)20 8600 4800 mail@lds-uk.com

project

Tesco store site  
 Highbridge Road, Barking

client  
 EcoWorld International

drawing title

proposed Temporary Tesco store and car park - ground floor plan

scale at A1	scale at A3	drawn	date
1:250	1:500	RF	12.20

job no.	drawing	rev.
1133	A1200	G